



Norman Road, St. Leonards-On-Sea TN38 0EG

Offers in excess of £500,000



Beautifully presented two bedroom TERRACED HOUSE with a DRIVEWAY occupying a SOUGHT AFTER LOCATION. It's ideally located just a short stroll from the beach in the HEART OF ST LEONARDS enjoying artisan shops, award winning local eateries and galleries along with a mainline railway station with connections to London. This PERIOD RESIDENCE relishes a WEALTH OF ORIGINAL FEATURES with accommodation set across THREE STOREYS with the ground floor arranged as a bright OPEN PLAN LIVING SPACE which benefits from a DUAL ASPECT with double doors leading out to the rear courtyard and measures an impressive 14'7 x 24'2. The MODERN FAMILY BATHROOM is also found on this floor along with a handy UTILITY SPACE. The lower ground floor houses the STYLISH EAT-IN KITCHEN which is fitted to provide ample storage space and offers plenty of room for a dining table. The TWO DOUBLE BEDROOMS can be found on the first floor with the main bedroom enjoying BUILT IN STORAGE. To the front of the property there is a SOUTH FACING TERRACE which can also be used as a DRIVEWAY providing off road parking for one vehicle. Set in a CENTRAL LOCATION, this fantastic property is not one to be missed.

BASEMENT LEVEL
190 sq.ft. (17.6 sq.m.) approx.

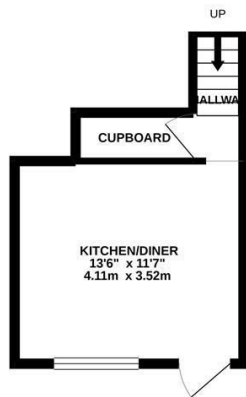

GROUND FLOOR
408 sq.ft. (37.9 sq.m.) approx.

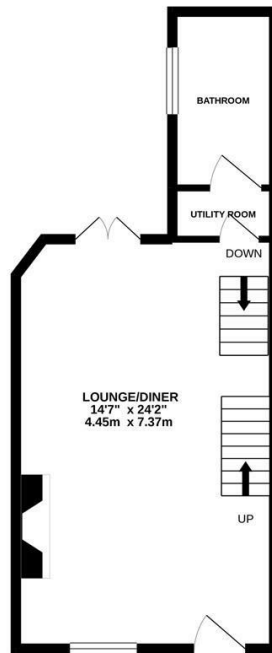

1ST FLOOR
321 sq.ft. (29.8 sq.m.) approx.

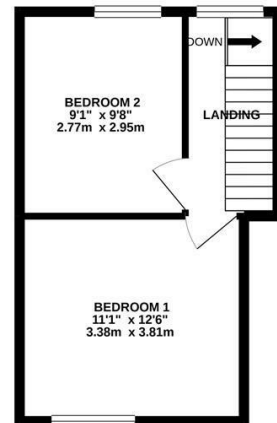

TOTAL FLOOR AREA : 918 sq.ft. (85.3 sq.m.) approx.

Whilst every attempt has been made to ensure the accuracy of the floorplan contained here, measurements of doors, windows, rooms and any other items are approximate and no responsibility is taken for any error, omission or mis-statement. This plan is for illustrative purposes only and should be used as such by any prospective purchaser. The services, systems and appliances shown have not been tested and no guarantee as to their operability or efficiency can be given.

Made with Metropix ©2020

